

# The Times Center

## HALL SPECIFICS

### Dimensions

74' 3" long by 66' 9" wide  
Roughly 5,000 sq. ft.

Outer ceiling 12' 10"

Inner ceiling 11' 11"

### Walls & Floor

Room has gray wall-to-wall carpet and white walls

### Entrance

TheHall has three sets of wooden double-doors that lead out to the lower lobby

### Note

The venue strictly prohibits hanging or taping anything to the walls of the space

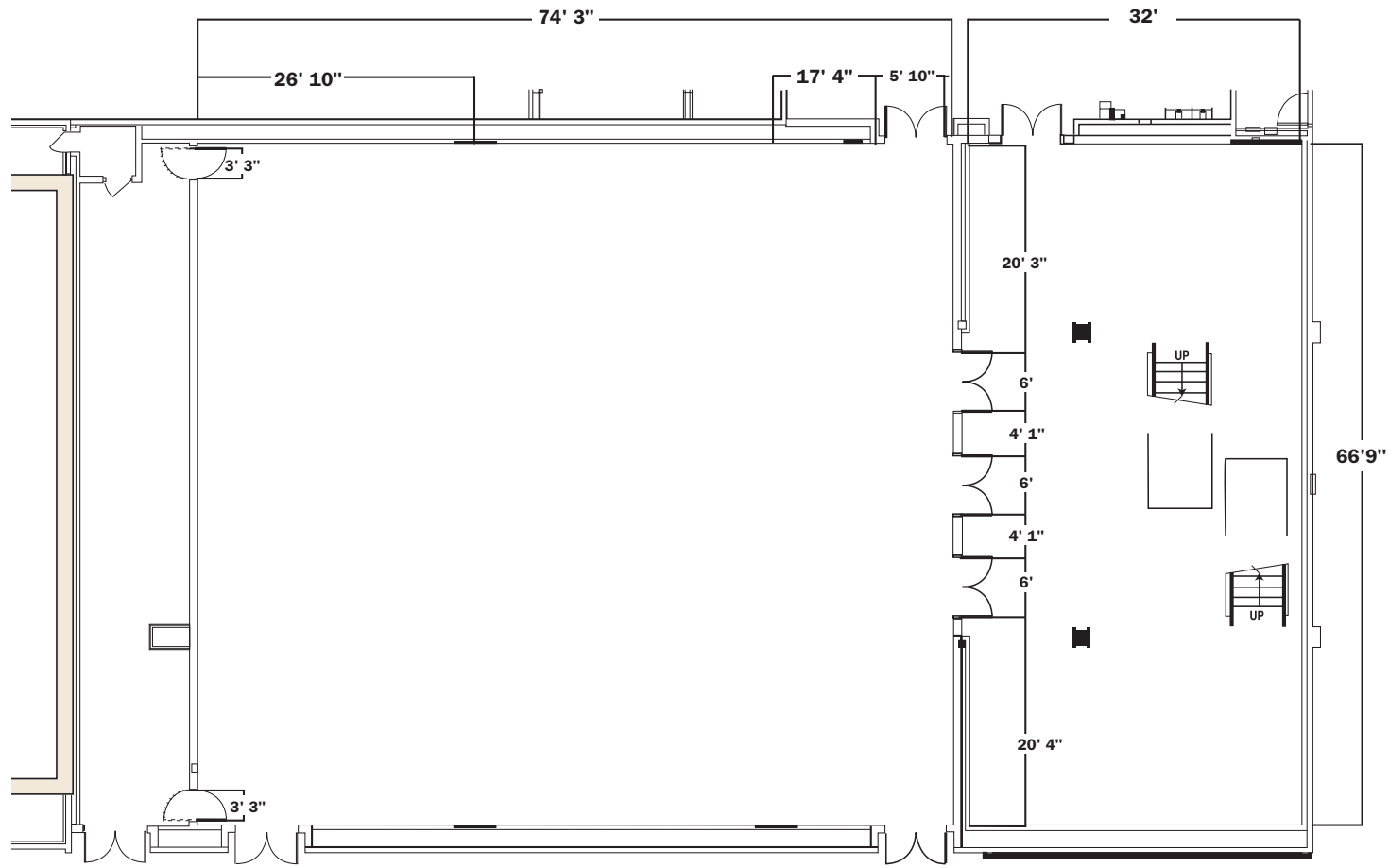

# The Times Center

## HALL FLOOR PLAN: SEATED DINNER

Banquet Style  
Total Seating: 350

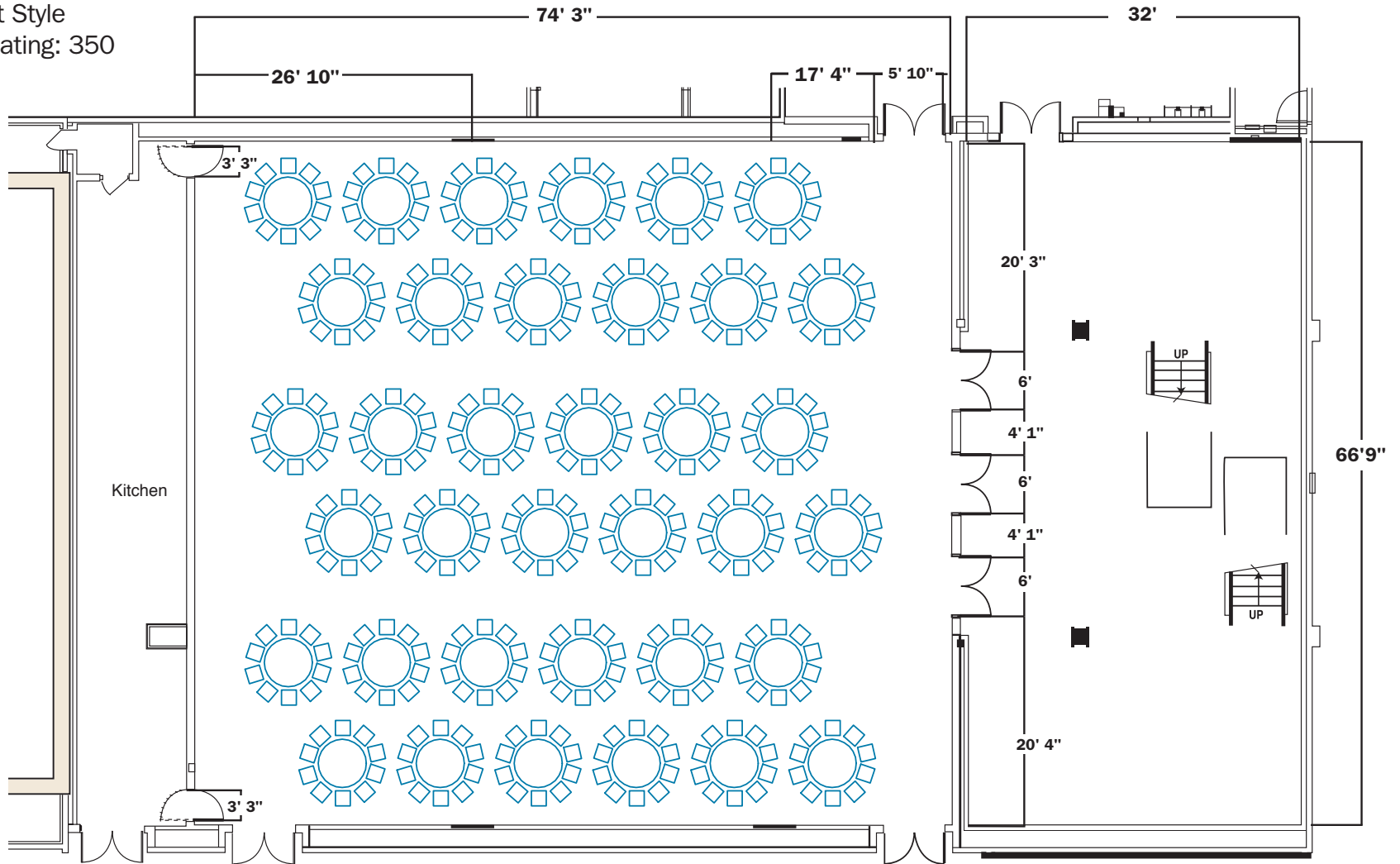

# The Times Center

## HALL FLOOR PLAN: SEATED DINNER WITH STAGE

Seating: 200

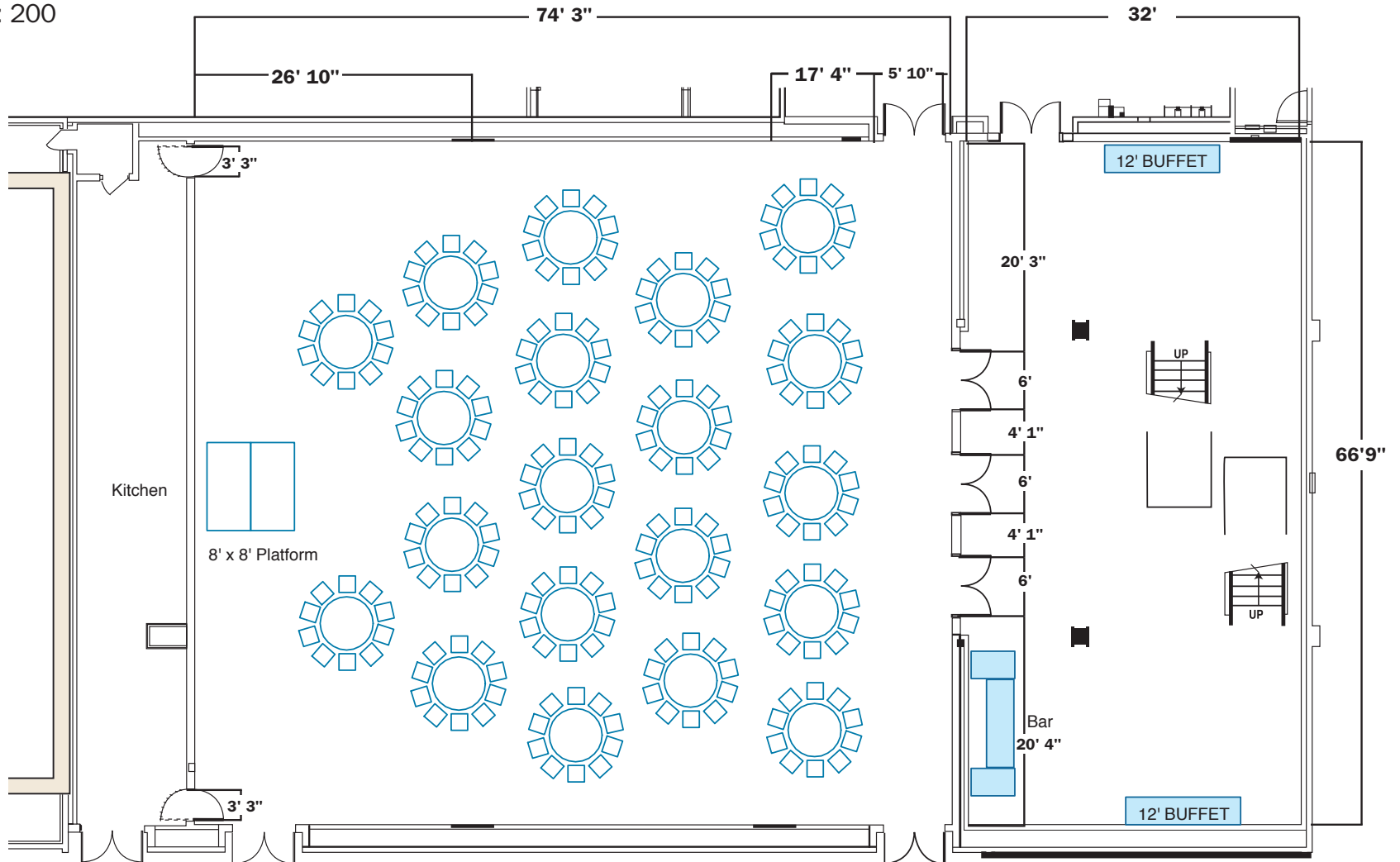

# The Times Center

## HALL FLOOR PLAN: SEATED DINNER WITH CENTER BUFFETS

Seating: 230

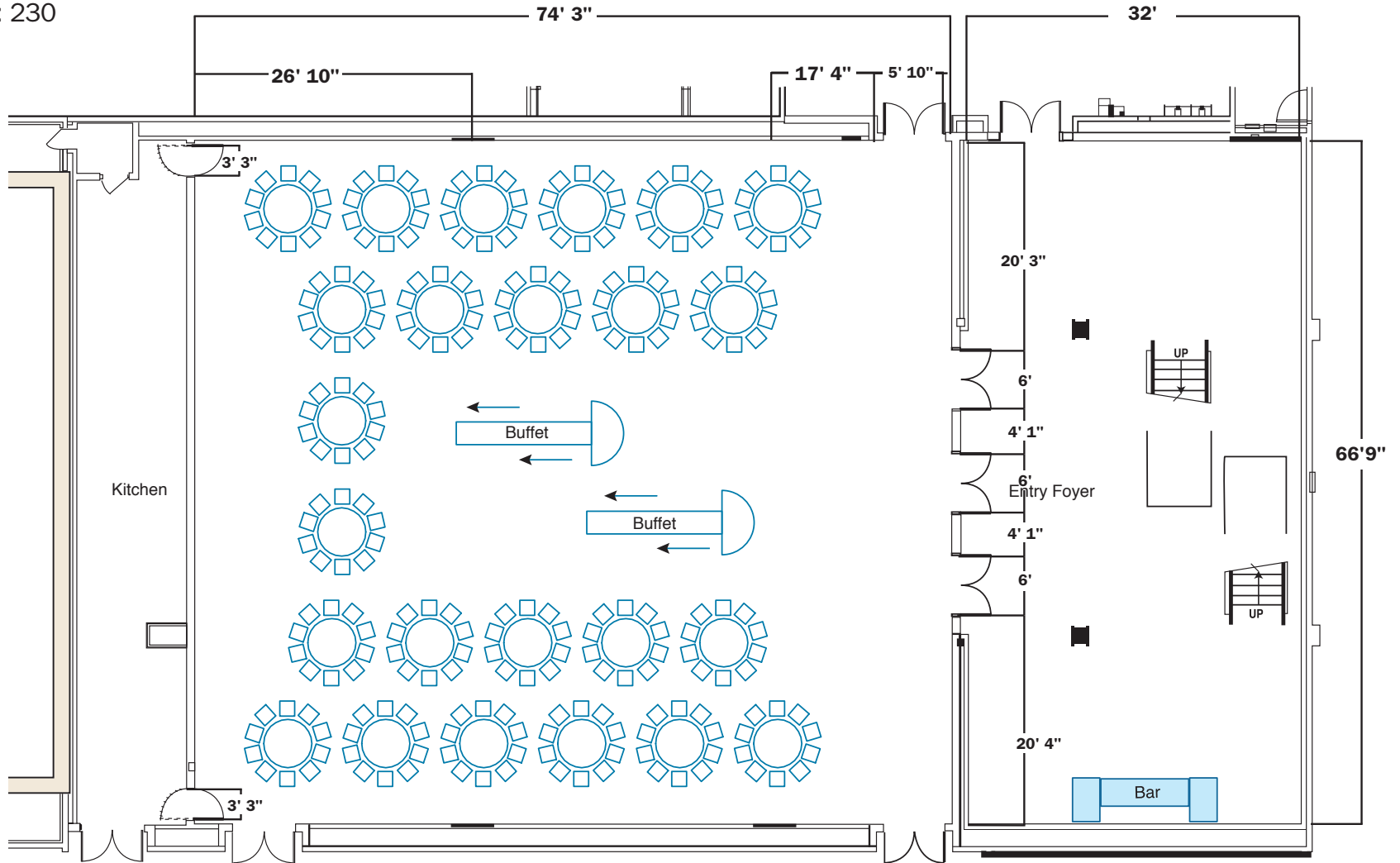

# The Times Center

## HALL FLOOR PLAN: SEATED DINNER WITH SIDE BUFFETS

Seating: 240

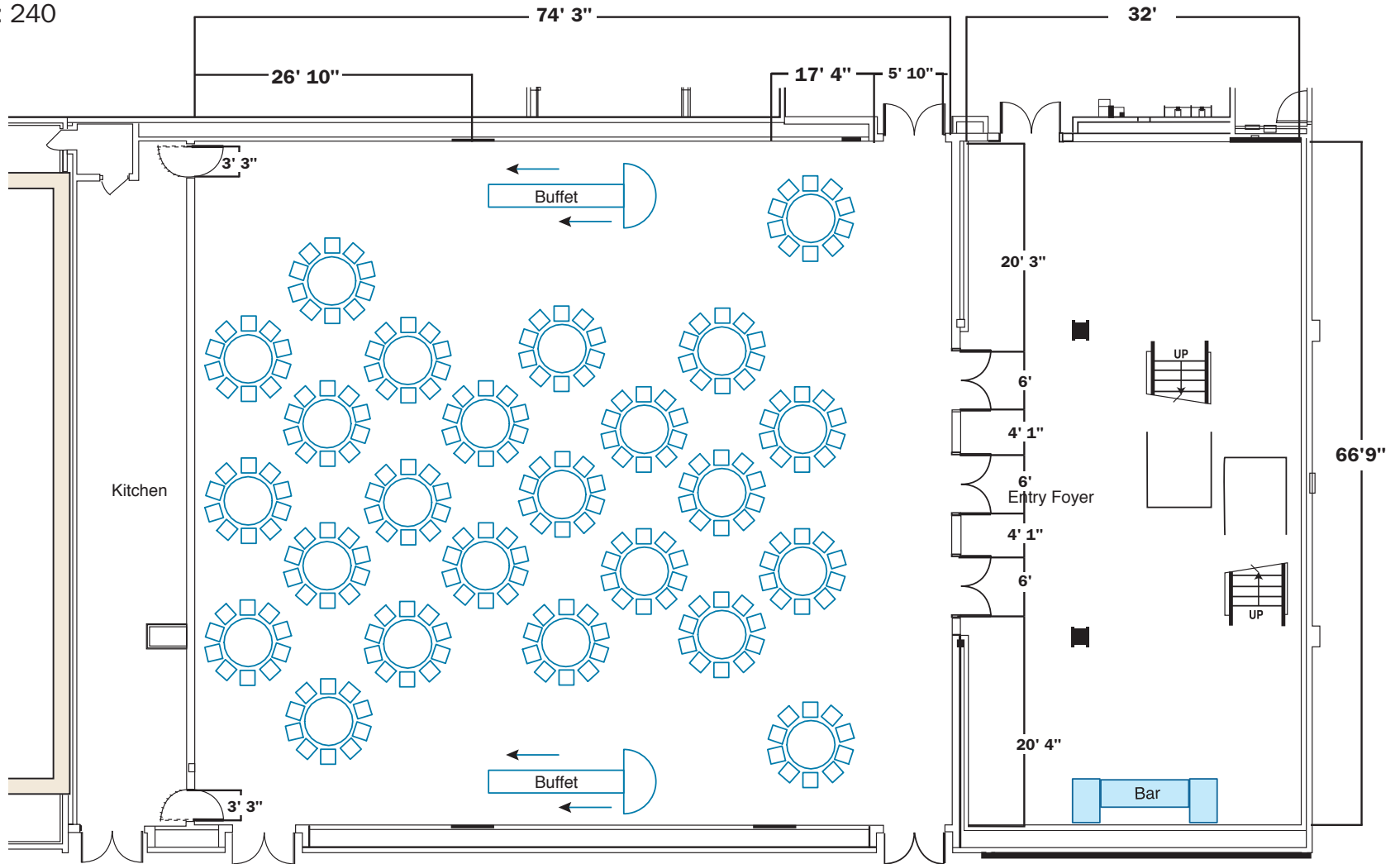

# The Times Center

## HALL FLOOR PLAN: COCKTAIL RECEPTION

350 – 400 capacity,  
including lower lobby

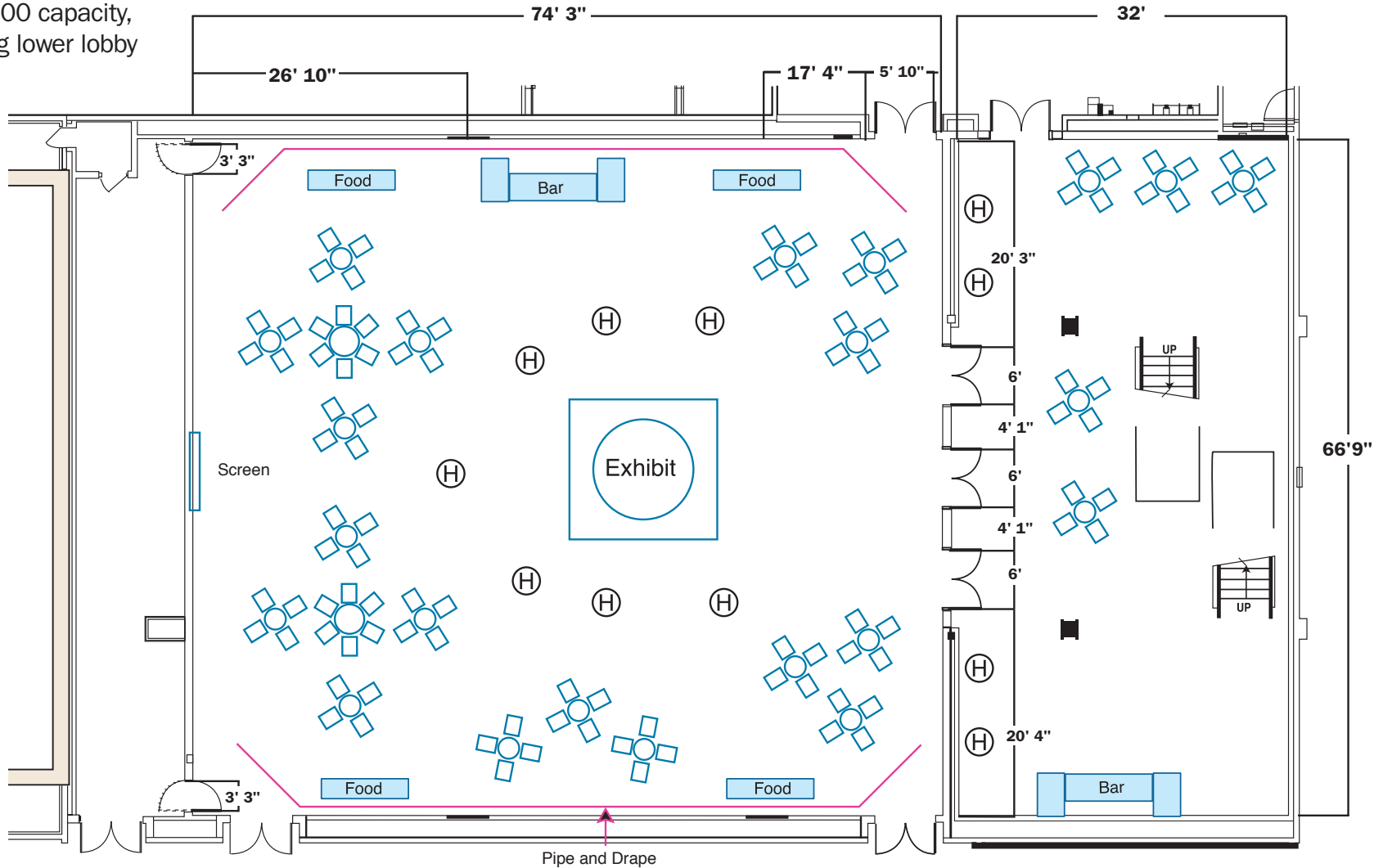

# The Times Center

## HALL FLOOR PLAN: COCKTAIL RECEPTION WITH CENTER BUFFETS

350 – 400 capacity,  
including lower lobby

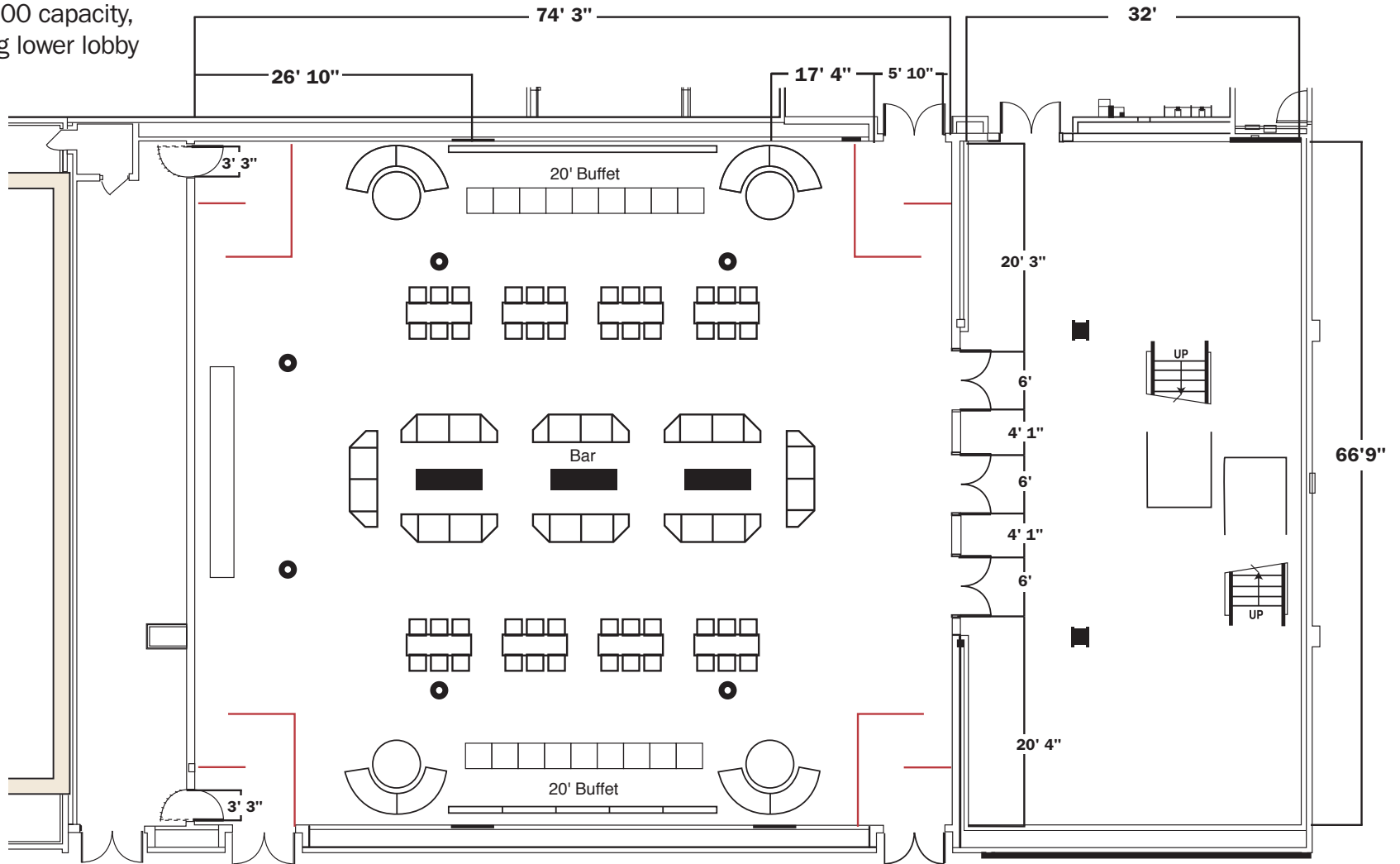

# The Times Center

## HALL FLOOR PLAN: THEATER STYLE SEATING

Total Seating: 390

